





Installation Manual

HOFA Curtain Rod Set Heavy

Wall Mount with Wall Brackets

Accessory Parts:

Rod		Length and number of pieces depending on the total length of the system
Base Plate		Number depends on the length of the rod
Cover Plate		One cover plate per base plate
Wall Bracket		One wall bracket per base plate
End Cap		Usually, one end cap is required at each outer end of the rail.

Mounting Parts not Included

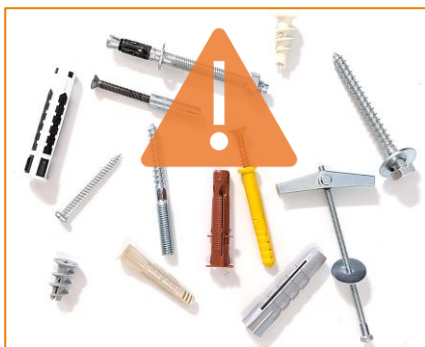

For safety reasons, we do not include dowels and screws for fitting heavy curtains.

The correct selection of suitable fastening components depends on the surface. If in doubt, please check the load-bearing capacity of the surface and the choice of dowels and screws with a specialist.

General Information:



We recommend that two people carry out the installation. Secure fastening and the correct choice of screws and wall plugs always depend on the condition of the wall or ceiling and can only be correctly assessed on site. If in doubt, please consult a tradesperson.



For trouble-free installation, the surface should be as even as possible. Woodchip wallpaper is normally not a problem. On very uneven surfaces, such as natural stone, for example, installation is very difficult or even impossible. On slightly uneven surfaces, e.g. in old houses, the installation of non-split rails is usually also possible.



If you have any questions during the installation of the system, please do not hesitate to contact us by phone or e-mail: <https://hofa-akustik.de/en/kontakt/>

Tools and Equipment Required:

- Drilling machine with drill bit
- Cordless screwdriver with bit
- Allen key mm
- Spirit level
- Pen
- Depending on the surface (additionally): mounting adhesive for gluing in the dowels

Overview:

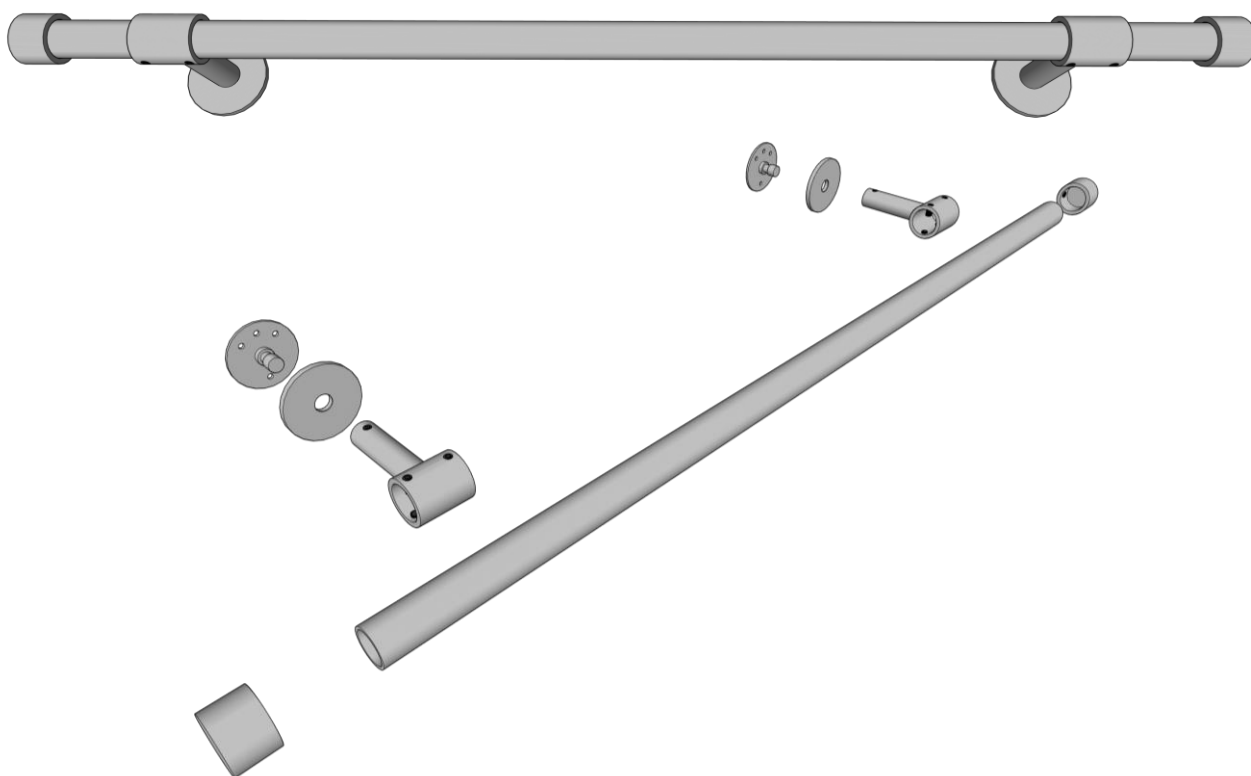

Positioning of the Holders

To install the curtain flush with the ceiling using a curtain rod, the distance from the top edge of the rod to the ceiling must be approx. 2.7 - 3 cm.

The distance between the wall brackets and the end of the rod can be selected according to the best visual impression.

Example for 200 cm rod length and upper curtain edge flush with the ceiling:

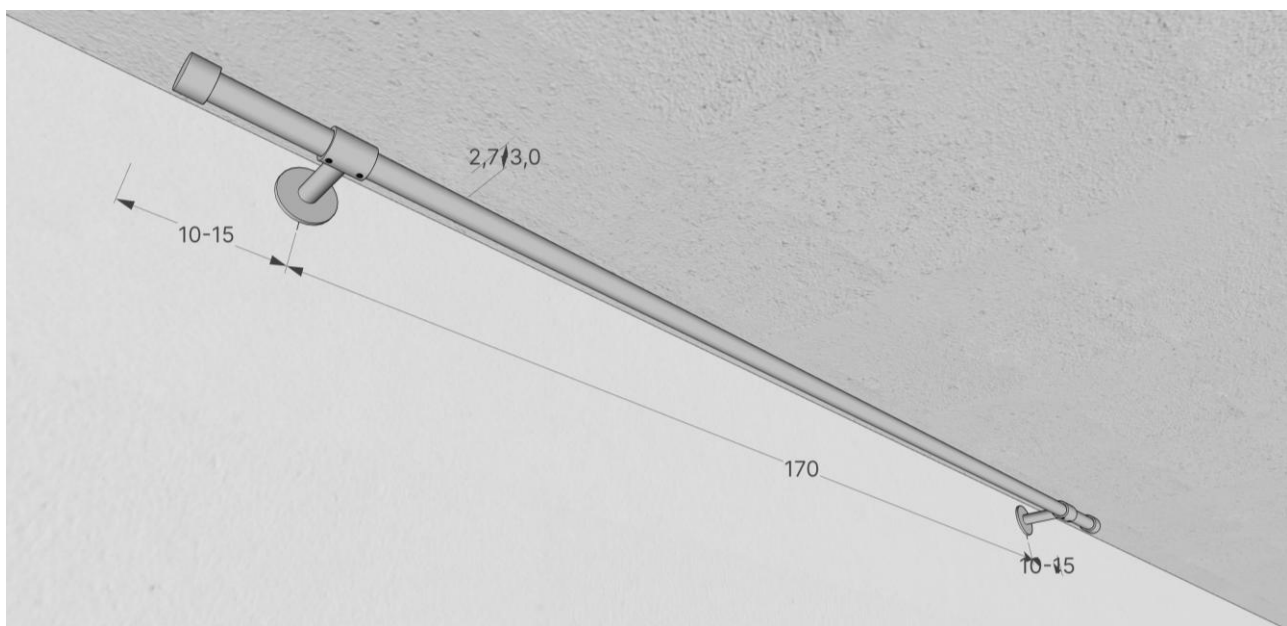

Example for 370 cm rod length (split rod) and upper curtain edge flush with the ceiling:

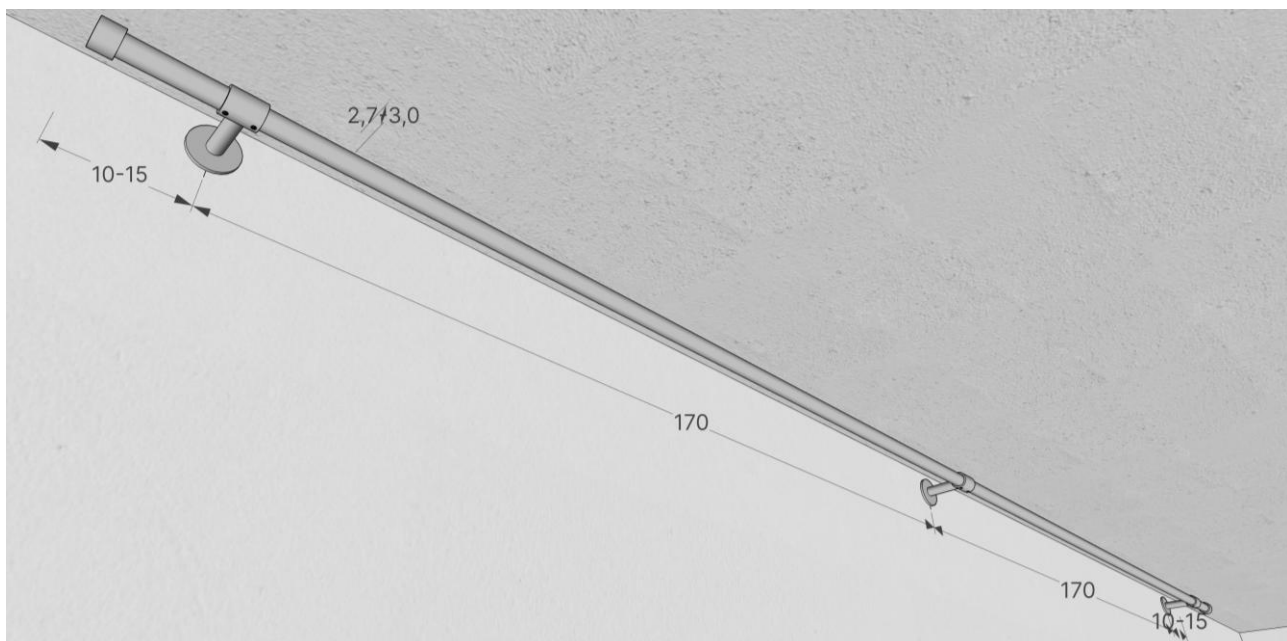

Mounting Steps for Installation

Step 1

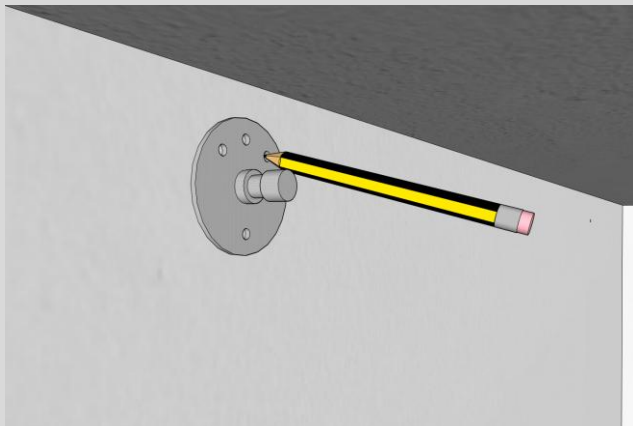

Mark the drill holes using the base plate of the wall bracket.

Step 2

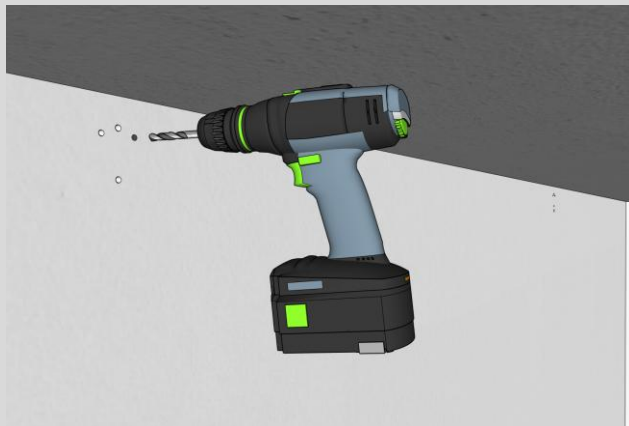

Drill holes and insert dowels.

Step 3

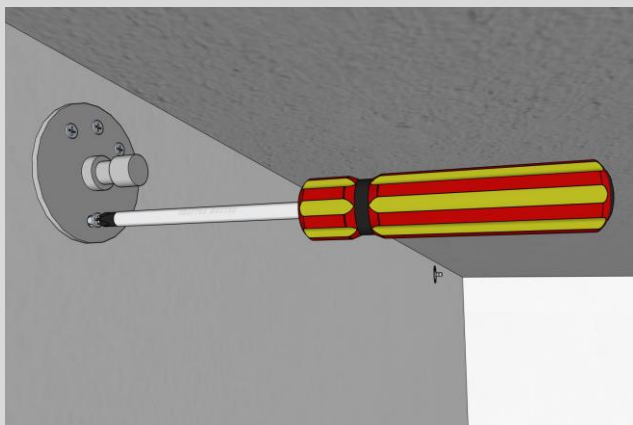

Screw both base plates to the wall.

Step 4

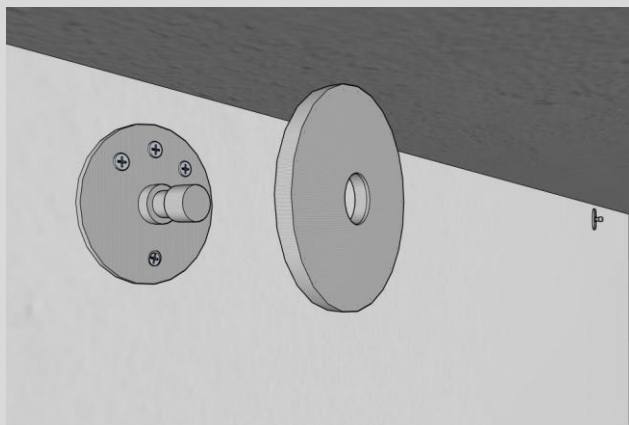

Attach the covers to the base plates.

Step 5

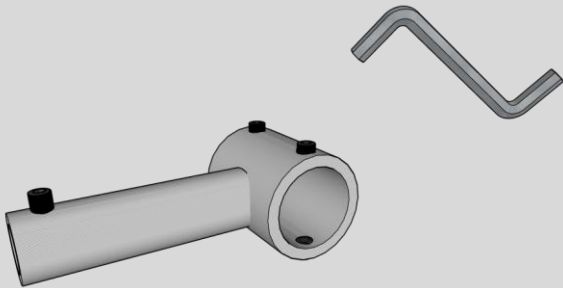

Loosen all grub screws on the wall bracket using an Allen key.

Step 6

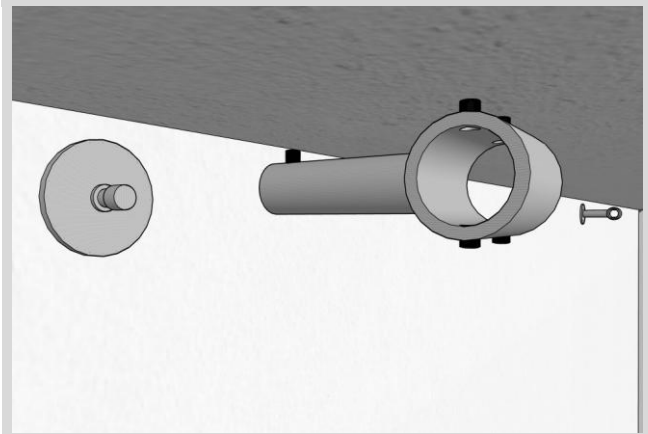

Attach both wall brackets to the base plate...

Step 7

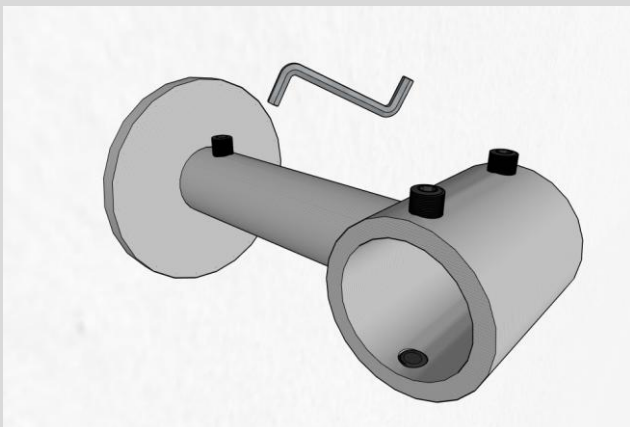

... and secure each one horizontally using the grub screw.

Step 8

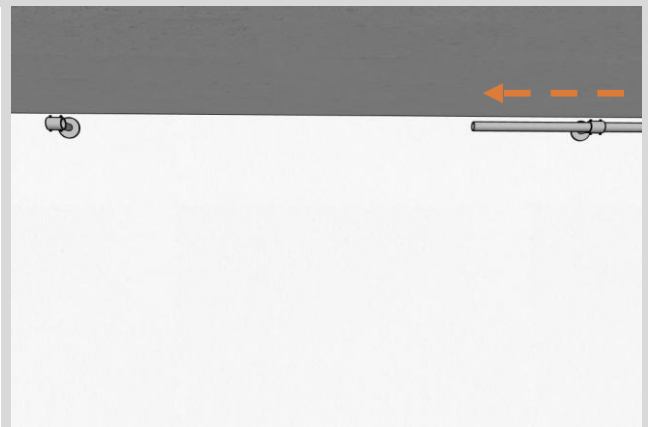

Insert the rod into one of the holders from the side.

Step 9

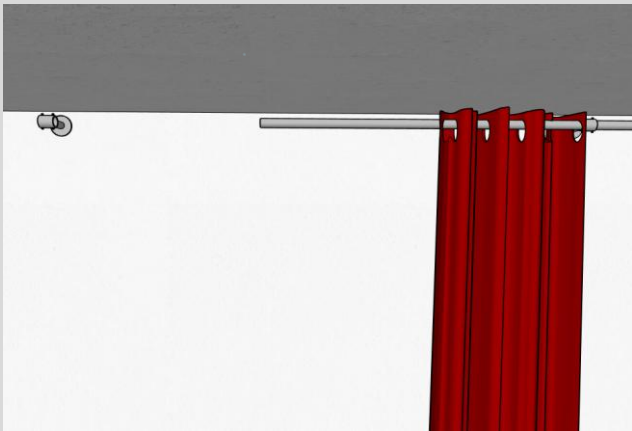

Thread the curtain in...

Step 10

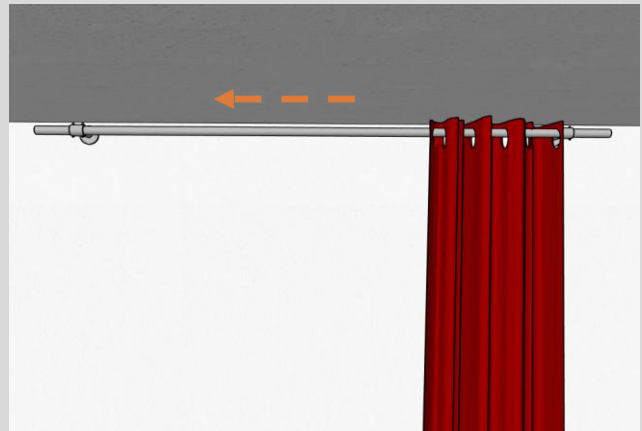

Thread the rod through the second wall bracket. If the rod is split, insert both rods into the middle bracket up to the center.

Step 11

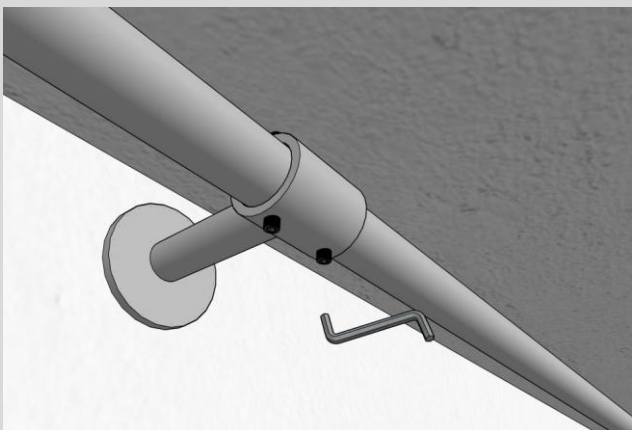

Tighten all 4 grub screws on the wall bracket evenly at the top and bottom.

Step 12

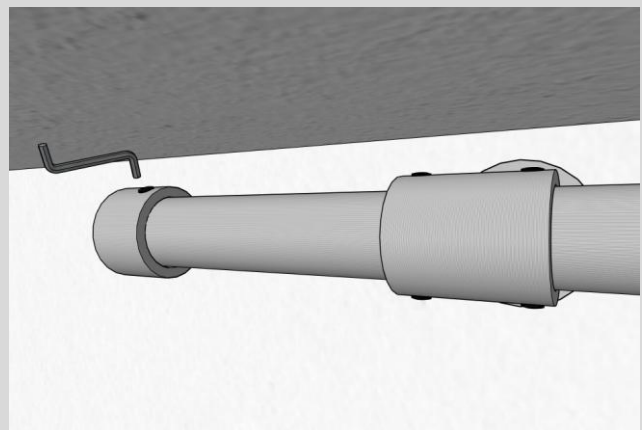

Attach one end cap to each end of the rod.

Care Instructions:

The HOFA Curtain Rod Set Heavy does not require any special maintenance; it should be protected from moisture, though.

► HOFA-Akustik

Phone: +49 7251 3472-400 | **Mail:** akustik@hofa.de | hofa-akustik.de/en

- **HOFA-Plugins** - Premium plugins for a perfect workflow when producing, mixing, and mastering.
- **HOFA-College** - The international online academy for audio engineering and music production.
- **HOFA-Media** - Your experienced partner for high-quality CD and pressing.
- **HOFA-Studios** - Recording, mixing & mastering in one of the most renowned recording studios in Germany.

hofa-plugins.de/en
hofa-college.de/en
hofa-media.de/en
hofa-studios.de/en

HOFA GmbH

Lusshardtstraße 1 -3, 76689 Karlsdorf | Phone 07251 / 3472 – 0 | Mail office@hofa.de | www.hofa.de/en
Managing Director: Jochen Sachse, Jan Bönisch | District Court Mannheim HRB Nr. 231615